

TYPICAL TRAVEL LANE SECTION
NTS

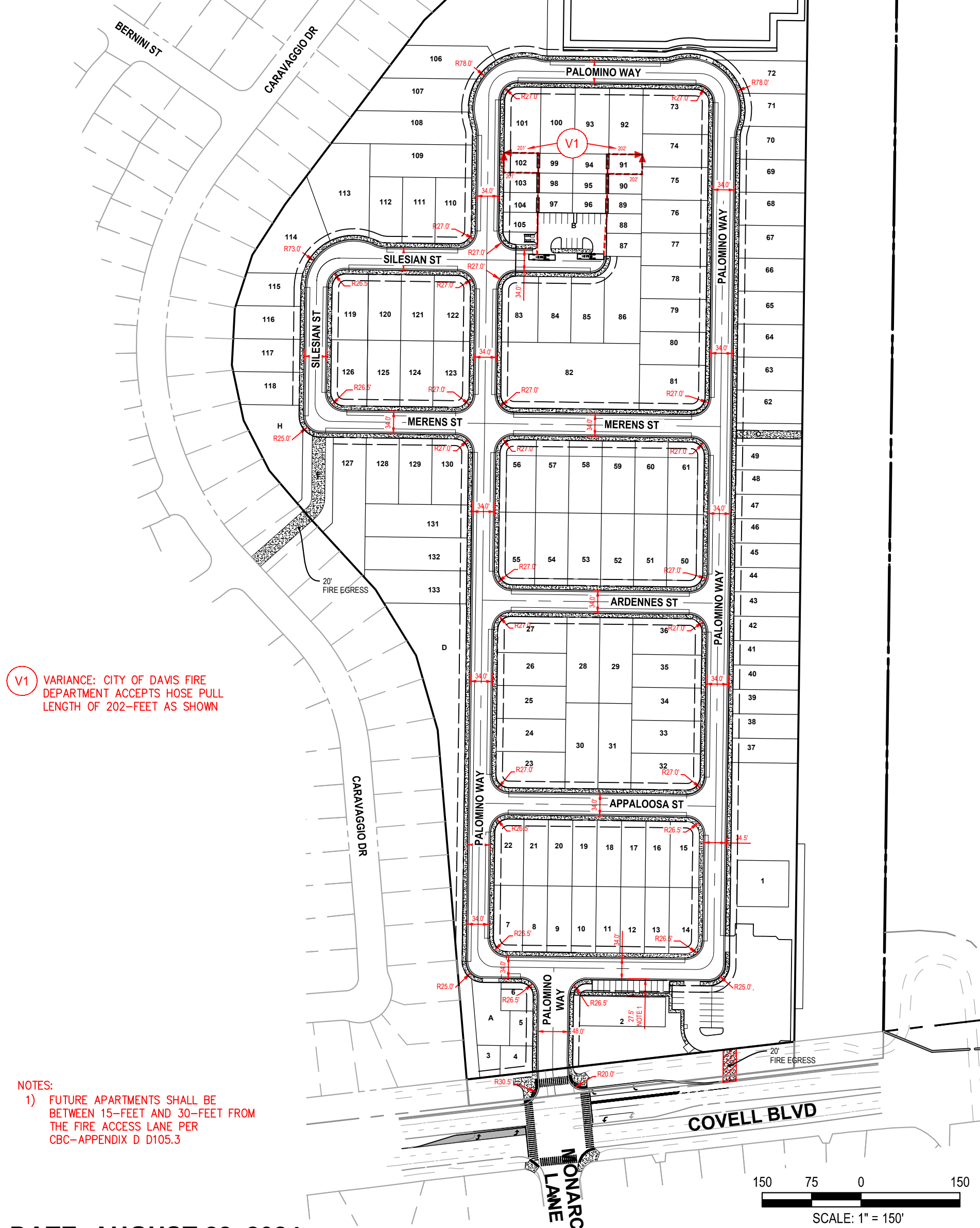

V1 VARIANCE: CITY OF DAVIS FIRE DEPARTMENT ACCEPTS HOSE PULL LENGTH OF 202- FEET AS SHOWN

- NOTES:
- 1) FUTURE APARTMENTS SHALL BE BETWEEN 15- FEET AND 30- FEET FROM THE FIRE ACCESS LANE PER CBC-APPENDIX D D105.3

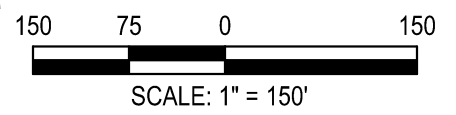

DATE: AUGUST 22, 2024

DESIGNED	DR
DRAWN	DR
CHECKED	BF
JOB No:	1807.00.06

PALOMINO PLACE
PROPOSED FIRE LANE ACCESS PLAN

DAVIS CALIFORNIA

CUNNINGHAM ENGINEERING

Project Planning ■ Civil Engineering ■ Landscape Architecture

Sacramento Office 2120 20th Street, Suite Three Sacramento, CA 95818 (916) 455-2026	Davis Office 2940 Spafford Street, Suite 200 Davis, CA 95618 (530) 758-2026
--	--

CECWEST.COM

SCALE 1"=150'	DATE 08/22/2024
↑	SHEET F1